

## DRILLED BAR STOCK THERMOWELL BORED – SOCKET-WELD – STRAIGHT

### BSS (Bored Socket-weld Straight)

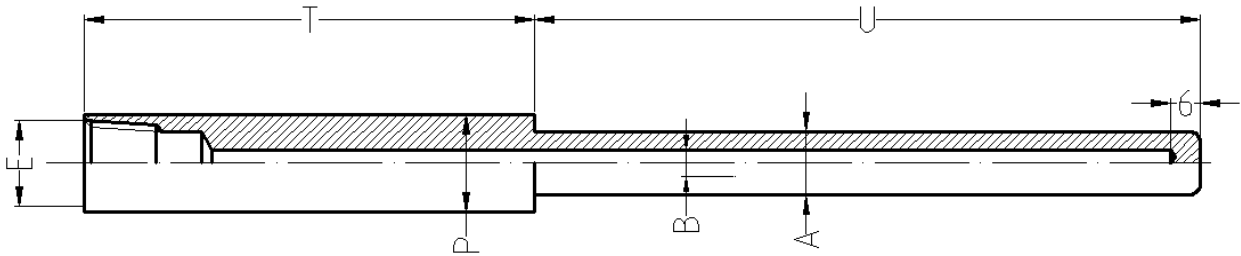

### BSSR (Bored Socket-weld Straight Reduced)

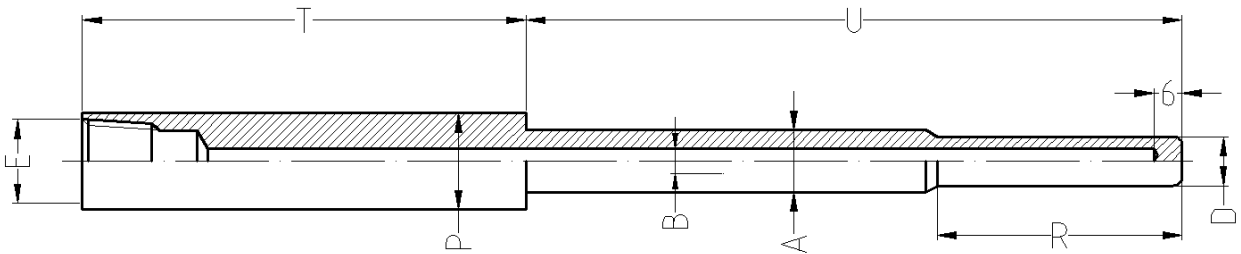

### Features

Our thermowells are machined and drilled from solid bar stock. This results in a non-welded unit. High accuracy machines are used to ensure concentricity of the bore with respect to the outside diameter and a consistent wall thickness over the full length of the thermowell. Our bar stock thermowells with tapered stem have been designed for various fluids and pressure applications. Metric and fractional connections.

### Technical specifications

- Tolerances : all dimensions +/- 1 mm except B : +/- 0.15 mm
- Standard finish  $1.6 < Ra < 3.2 \mu$
- Material : wide range of materials available as per DIN 10088 /AISI-ASTM and many others
- Reduced tip : OD 12 mm over length R in mm

| ORDERING INFORMATION        |                     |              |               |              |              |                   |               |
|-----------------------------|---------------------|--------------|---------------|--------------|--------------|-------------------|---------------|
| Materials                   | <b>M2101</b>        | <b>M2103</b> | <b>M2108</b>  | <b>M2118</b> | <b>M0601</b> | <b>M0703</b>      | <b>M0803</b>  |
|                             | SS304L              | SS321        | SS316L        | SS310S       | Inconel 600  | Incoloy 800HT     | Hastelloy C22 |
|                             | 1.4307              | 1.4541       | 1.4404/1.4435 | 1.4845       | 2.4816       | 1.4959            | 2.4605        |
| Welding Connection diameter | <b>P20</b>          | <b>P25</b>   | <b>P05</b>    | <b>P06</b>   | <b>P07</b>   |                   | <b>Other</b>  |
|                             | 20 mm               | 25 mm        | ½" (21.3 mm)  | ¾" (26.7 mm) | 1" (33.4 mm) |                   |               |
| Stem                        | A                   | A            | A             | A            | A            |                   | AC            |
|                             | 16                  | 18           | 16            | 22           | 28           |                   | Customer spec |
| Instrument Connection       | <b>E205</b>         | <b>E405</b>  | Other         |              |              | <p>Domed Tip:</p> |               |
|                             | ½" G                | ½" NPT       |               |              |              |                   |               |
| Bore                        | 6.5                 | 7            |               |              |              |                   |               |
| Options                     | Ra                  | Domed tip    |               |              |              |                   |               |
|                             | Indicate value stem | DT           |               |              |              |                   |               |

| Code          | Certificates                                    |
|---------------|---|
| <b>Q701MC</b> | Material certificate En10204-3.1                |
| <b>Q625ND</b> | External pressure test report (liquid)          |
| <b>Q610ND</b> | Internal pressure test report (liquid)          |
| <b>Q665NT</b> | PMI testing after construction by third party   |
| <b>Q820CC</b> | Test report EN10204-2.2                         |
| <b>Q120ED</b> | Wake frequency calculation on process condition |

| HOW TO ORDER (example)       |                                     |         |           |
|------------------------------|-------------------------------------|---------|-----------|
| Code                         | Description                         | Example | Your code |
| <b>Type</b>                  | Thermowell type                     | BSSR    |           |
| <b>Material</b>              | Thermowell material SS316L          | M2108   |           |
| <b>Welding Connection</b>    | Diameter for welding part 20 mm     | P20     |           |
| <b>Instrument connection</b> | Connection for the instrument ½"NPT | E405    |           |

|                |  |        |  |
|----------------|--|--------|--|
| <b>B</b>       | Bore diameter 6.5 mm                     | B6.5   |  |
| <b>U</b>       | Length under process thread (R included) | U150   |  |
| <b>R</b>       | Reduced tip length in mm if required     | R30    |  |
| <b>T</b>       | Total length                             | T80    |  |
| <b>A</b>       | Stem diameter 17 mm                      | AC17   |  |
| <b>Options</b> | Domed tip                                | DT     |  |
| <b>Q701MC</b>  | Material certificate EN10204-3.1         | Q701MC |  |

Ordering example

BSSR M2108 P20 E405 B6.5 U150 R30 T80 AC19 DT Q701MC

|  |
|--|
| <b>For all options: please contact Rodax</b> |
|--|